



# Welcome!

# Summer 2024

To our Summer edition of the Schools Stay Safe Newsletter.  
Read on for advice on ways to stay safe for you and your family.

## Don't Drink and Drive.

Driving under the influence of alcohol is a criminal offence. Being found guilty of driving while above the legal drink-driving alcohol limit will result in punishment that could affect the rest of your life.

- Drink driving is a dangerous and punishable offence, which can seriously impact the safety of our roads and put other road users at risk.
- The offence can land drivers with a fine, or even a driving ban, which can have a negative impact on car insurance premiums.
- Units of alcohol can be hard to work out so opt for non alcoholic alternatives.
- To avoid getting caught out, we suggest drivers stop drinking early if you know you have to get behind the wheel in the morning, but the best advice would be to avoid drinking alcohol at all.
- If you really want to have a drink, assign a designated driver, book a taxi or use public transport



[Drink driving penalties](#) | [Drinkaware](#)



## Water Safety on our Coasts

Heading to the coast or out on the water is a great way to have fun and stay active. However, conditions can change quickly and if you're not prepared, you can easily get caught out.

- Choose a lifeguarded beach and only swim between the flags.
- Check the weather, tides, and be aware of rip currents.
- Be visible – wear something bright!
- Do not swim if you are alone!
- Remember – FLOAT TO LIVE!
- Carry your mobile phone in a waterproof pouch just incase!

[Water Safety Advice And Tips - Know The Risks \(rnli.org\)](https://www.rnli.org)

[Hertfordshire County Council | Be ready for hot weather in 2024](#)





## Fire Safety Intervention

Children and young people who have displayed fire setting behaviour or a fire fascination can receive free intervention from Herts Fire & Rescue. If you are concerned about a child or young person that has a fascination with fire, you can refer to the scheme. We will accept referrals from parents / guardians or any concerned agency, however intervention can only take place with parental consent.

### Signs of regular fire-setting:

- Small burn holes in carpets and / or furniture
- Charred paper in sinks or bins
- Matches or lighters hidden in bedrooms, school bag or coat
- An unusual fascination with fire
- Unexplained fires in the home

### Early intervention is key.

Visit our website and complete the online form:

[www.hertfordshire.gov.uk/fire](http://www.hertfordshire.gov.uk/fire)

[Worried about a child or young person's behaviour around fire? | Hertfordshire County Council](#)

## Button batteries – risk of injury or death if swallowed - where are they?

### Everywhere! Are they secure? Have a look at home:

- Watches, key fobs, torches, hearing aids
- Digital thermometers, bathroom scales, light-up water toys
- Wireless game controls, remote controls
- Flashing jewellery, clothing, shoes, toys, LED fairy/strip lights
- Flameless candles, tea lights, musical greetings cards

### Children are most at risk from 1 to 4 years. Older children too.

If batteries not secure contact **Trading Standards** through the Citizens Advice link: [Reporting to Trading Standards - Citizens Advice](#)

Other information available at external websites:

[Button Battery Safety | Child Accident Prevention Trust \(capt.org.uk\)](#)

[https://assets.publishing.service.gov.uk/media/60af8b868fa8f5489723d14c/6.7113 BEIS OPSS Button battery campaign 2020 A5-Lflt v4 web.pdf](https://assets.publishing.service.gov.uk/media/60af8b868fa8f5489723d14c/6.7113_BEIS_OPSS_Button_battery_campaign_2020_A5-Lflt_v4_web.pdf)





## Are you aware of Staywise?

Staywise is an interactive website packed full of fun activities from the UK's leading emergency services and safety-focused organisations, making it easy for you to find trusted activities that provide learning opportunities to help keep you safe.

There is lots to do on there for children and they are learning as they play!



## Have you tested your smoke detector lately?

Do you have a night-time routine?

Would you know how to escape in the unlikely event of a fire?

We encourage you to book yourself a free safe and well visit today. The local station numbers are at the bottom of this newsletter.

Don't forget, the visit is free!

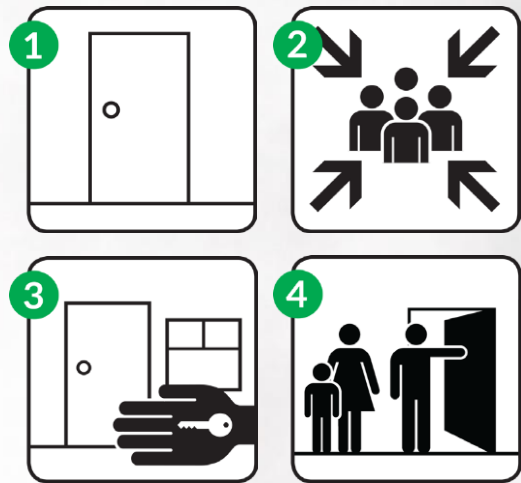

If you need any further information or advice on any of these topics, please feel free to call our friendly staff at your local station:

**Stevenage Fire Station**

**01438 202500**

**[Stevenage.fire@hertfordshire.gov.uk](mailto:Stevenage.fire@hertfordshire.gov.uk)**

**Hitchin Fire Station**

**01462 666800**

**[Hitchin.fire@hertfordshire.gov.uk](mailto:Hitchin.fire@hertfordshire.gov.uk)**



Hertfordshire Fire and Rescue Service



Hertfordshire Fire and Rescue  
Community Safety



[www.hertfordshire.gov.uk/fire](http://www.hertfordshire.gov.uk/fire)

[Fire, Rescue and Being Prepared | Hertfordshire County Council](#)